



Business: 641-394-2500  
E-mail: pschwick@FirstChoiceRealty1.com

FAX: 563-238-3341  
www.FirstChoiceRealty1.com

Home: 641-394-2637 Cell: 319-240-6879  
www.seeiowahomes.com



STYLE:	2 STORY	SMOKE ALARMS:	YES
BUILT IN:	1880	ANTENNA:	NO
SQ. FT.:	SEE DIAGRAM	CABLE:	AVAILABLE
TAXES:	\$354.00	INSULATION:	YES
POSSESSION:	30 days	PATIO:	NO
TERMS:	CASH	PORCHES:	YES
LOT SIZE:	66' X 132'	DECK:	
HOME FACES:	WEST	ATTIC:	
SCHOOL DIST.:	NEW HAMPTON	FIREPLACE:	NO
PHONE SERVICE:	NEW HAMPTON	AIR CON.:	YES-NEW
CONSTRUCTION:	WOOD FRAME	BUDGET:	UNKNOWN
ROOF TYPE:	GABLE/ASPHALT	W. SOFTENER:	NO
INTERIOR WALLS:	DRYWALL	W. HEATER:	.YES (ELEC.)-NEW
SIDING:	VINYL	WATER:	CITY
SUMP PUMP:	NO	SEWER:	CITY
LP TANK:	NA	HEATING:	FA/NG-NEW
GARAGE:	12' X 20' DETACHED	ELEC.:	CITY
BASEMENT:	768 SQ FT	220:	YES
B. FLOOR:	CONCRETE (MOST)	FLOOR DRAIN:	YES
DRIVEWAY:	CONCRETE	FLOOD ZONE:	NO
FOUNDATION:	STONE & CONCRETE		

FLOOR PLAN	MAIN LEVEL	UPPER LEVER	LOWER LEVEL
BACK PORCH (ENCL)	X		
LIVING ROOM	X		
DEN/OTHER			
REC. ROOM			
DINING ROOM	X		
DINING AREA			
KITCHEN	X		
BATH	X	1/2	
BEDROOM/S	X	XX	
LAUNDRY	X		

APPLIANCES / ITEMS TO STAY:	All new, refrigerator, dishwasher, microwave and stove.
-----------------------------	---

ITEMS THAT DO NOT STAY:	
-------------------------	--

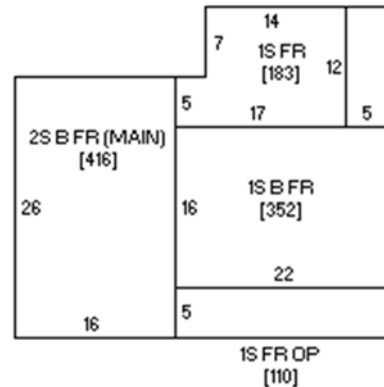

Owner: MLS #  
Legal: LOT 7, BLOCK 2 SOUTHVIEW ADDITION

**\$137,500.00**

**262 S. Chestnut Ave.**

**New Hampton**

**FIRST Choice REALTY**

105 E. Main St.  
New Hampton, IA 50659

LISTING #427

Completely redone! All new cupboards, flooring, wiring, plumbing, appliances, furnace, water heater, CA, drywall, insulation, light fixtures, siding, garage door and opener, porch decking and railings and much more! Ready to move in!

All information provided is deemed reliable but is not guaranteed by First Choice Realty or any agent affiliated with the MLS and should be independently verified.

